

A perfect coffee starts with a perfect machine. That's why Animo is proud to introduce the new and improved OptiBean Touch. The intelligent espresso machine with ready-to-go touchscreen, intuitive user interface and distinctive design. Simple to use and easy to maintain. Your perfect espresso is just one touch away.

BENEFITS

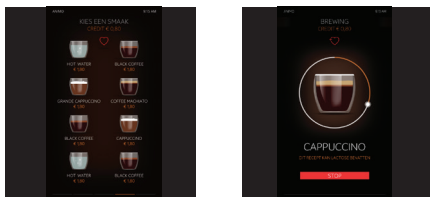

TOUCHSCREEN

- + Easy to operate through intuitive user interface
- + Simple swipe between pages
- + 24 easily programmable beverages
- + Follow the brewing process onscreen
- + Personal strength preferences are easily adjustable
- + Save personal preferences in 'favourites'
- + Screensaver for logo, images, video or advertisement



OB 2 (XL) Touch



OB 3 (XL) Touch



BREWER

- + Reversed brewer, quiet in operation, no drip
- + Delicious crema
- + Available with standard- or XL brewer for bigger, fuller cups



OPTIONS



- + Coloured front in any RAL colour
- + Compatible with many payment systems
- + Prepared for telemetry
- + Cup sensor
- + Hot and cold from one machine (cooling unit in base cabinet)
- + Company specific branding on the exterior of the machine

ACCESSORIES



- + Base cabinet (with or without cooling unit)
- + Stand-alone set with pump and water tank
- + Water filter to reduce maintenance
- + Cup heater
- + Thermos jug 1 l



MIXER SYSTEM

- + Adjustable mixer speed (rpm) for an excellent topping



- + Reversed espresso brewing system
- + Double outlet for the real espresso experience
- + Ready-to-swipe touchscreen
- + Intelligent user interface
- + Ceramic coffee grinder mechanism (Ditting®)
- + Canister for fresh coffee beans
- + Available with 1 or 2 canisters for instant ingredients
- + Make two cups at once (in 2 brewing cycles)
- + Separate taps for coffee and hot water
- + Water temperature control
- + Strength control (also for milk and sugar)
- + Adjustable OptiLight LED lighting
- + Intelligent Energy Saving Mode
- + Cleaning program (access on control panel)
- + Usage counter
- + Insulated stainless steel boiler
- + Adjustable cup tray
- + Suitable for cups and thermos jugs
- + Energy label A+

FRONT VIEW
All dimensions in millimeters.

SIDE VIEW RIGHT

BACKSIDE

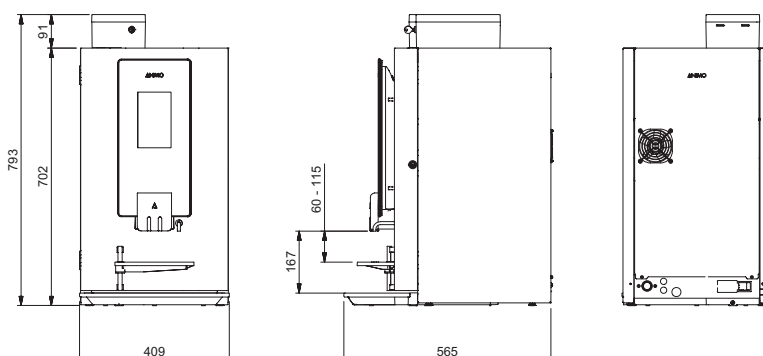

CAPACITY CANISTERS

	Bean hopper	Canister 1.6 l	Canister 3.8 l
Coffee beans	± 1500 gr / 200 cups	-	-
Topping	-	± 970 gr / 63 cups	± 2300 gr / 150 cups
Chocolate	-	± 1030 gr / 60 cups	± 2440 gr / 140 cups

+ The canisters can be enlarged easily to increase capacity

TECHNICAL SPECIFICATIONS

- + Brewing time per cup (120 ml): 25-30 sec
- + Hourly capacity: 120 cups (120 ml) / 14 l
- + Capacity brewer: 6.5 – 9.5 gr / 50-150 ml
- + Capacity XL brewer: 9.5 – 13.4 gr / 150-230 ml
- + Capacity boiler: 1.1 l (1800W)
- + Display: 7" touchscreen
- + Adjustable cup tray: 60 - 155 mm
- + Max. tap height: 167 mm
- + Rotary pump (Procon®): 10 bar
- + Power supply: 220-240V / 50-60Hz / 2275W
- + Water connection: 3/4"
- + Waste canister volume: 7 l (± 130 cups)

DRINK OPTIONS

Drink options depend on the ingredients that you select for each canister. Adjustable controls make it easy to change the options.

DRINK OPTIONS	OptiBean 2 (XL) TOUCH	OptiBean 3 (XL) TOUCH
Coffee (thermos jugs)	✓	✓
Coffee with milk	✓	✓
Espresso	✓	✓
Cappuccino	✓	✓
Latte Macchiato	✓	✓
Coffee choc	⊙	✓
Chocolate milk	⊙	✓
Wiener Melange		✓
Hot water	✓	✓
Espresso Choc	⊙	✓
Decaf	⊙	⊙
Tea	⊙	⊙
Coffee with sugar	⊙	⊙
Hot milk	⊙	⊙
Hot chocolate	⊙	⊙
Double Espresso	⊙	⊙
Cold water	◆	◆

- ✓ STANDARD FACTORY SETTINGS
- ⊙ ADJUSTABLE (DEPENDING ON CHOSEN INGREDIENTS)
- ◆ POSSIBLE WITH A COOLING UNIT IN THE BASE CABINET

AT EASE ANYWHERE

- + Office
- + Hotel
- + Restaurant
- + Supermarket
- + Hospital
- + Canteen
- + Breakfast room
- + Gas station
- + Kiosk
- + Athletic club
- + Care home
- + Exhibition centre
- + Airport
- + School
- + Theatre
- ... and many more.

